

FE 130

WIRE DRAG

Diagram No. 1251-2

NOAA FORM 76-35A

U.S. DEPARTMENT OF COMMERCE
NATIONAL OCEANIC AND ATMOSPHERIC ADMINISTRATION
NATIONAL OCEAN SURVEY

DESCRIPTIVE REPORT (HYDROGRAPHIC)

Type of Survey Wire Drag
Field No. HY-2151
Office No..... FE-130WD

LOCALITY

State Florida
General Locality Straits of Florida
Locality Off Main Channel Entrance
..... to Key West

19 54

CHIEF OF PARTY

LIBRARY & ARCHIVES

DATE December 16, 1954

☆ U.S. GOV. PRINTING OFFICE: 1976-669-441

NOTE: A new system for registering Field Examinations (FE's) was established in 1980. All FE's are consecutively numbered as shown hereon. The date shown in the new format is the actual date of survey. This material was previously registered as;

FE No.9 1954WD

FE 130
WIRE DRAG

FE No. 9

1954

WIRE DRAG

FE-130

Diag. Cht. No. 12.51-2

Form 504

U. S. COAST AND GEODETIC SURVEY

DEPARTMENT OF COMMERCE

DESCRIPTIVE REPORT

Type of Survey WIRE DRAG
To Supplement FE No 9, 1954
Field No. HY-2151 Office No. ~~HY-2151~~

LOCALITY

State Florida
General locality Straits of Florida
Locality Off main Channel Entrance to Key West

19454

CHIEF OF PARTY

LIBRARY & ARCHIVES

DATE DEC 10 1954

B-1870-1 (1)

**FE No. 9
1954
WIRE DRAG**

DEPARTMENT OF COMMERCE

U. S. COAST AND GEODETIC SURVEY

HYDROGRAPHIC TITLE SHEET

The Hydrographic Sheet should be accompanied by this form, filled in as completely as possible, when the sheet is forwarded to the Office.

REGISTER No. ~~H-7932~~ F.E. 9-1954 W.P.

Field No. ~~HX-2151~~

State Florida

General locality Straits of Florida

Locality Off Main Channel Entrance to Key West

Scale 1:20,000 Date of survey 25 April & 9 May 1954

Instructions dated 26 Sept. 1946, 21 March 1951, 27 January 1954

Vessel Ship HYDROGRAPHER

Chief of party L. S. Hubbard

Surveyed by L. S. Hubbard, W.J. Chovan, R.M. Stone, M.T. Paulson

Soundings taken by ~~fathometer, graphic recorder, double lead~~ wire drag

Fathograms scaled by - -

Fathograms checked by - -

Protracted by - -

Soundings penciled by - -

Soundings in ~~fathoms~~ feet at MLW ~~XIXIXIXIX~~

REMARKS: Supplemental survey and descriptive report to H-7932 dated 1951

J.H.S.

DESCRIPTIVE REPORT

To Supplement

Hydrographic Survey H-7932 (HY-2151)

25 April and 9 May 1954

Ship HYDROGRAPHER

Scale 1:20,000

L. S. Hubbard
Chief of Party

A. PROJECT:

This survey was made under Instructions of the Director to the Commanding Officer, Ship HYDROGRAPHER, for Project CS-328 and are dated 26 September 1946, 21 March 1951 and by Supplemental Instructions dated 27 January 1954.

B. SURVEY LIMITS AND DATES:

The survey is offshore of the Florida Keys and south and west of the entrance to the main channel to Key West, Florida. The survey covers an area approximately one mile in diameter and centered on the plotted position of the wreck listed in paragraph 6 of the Supplemental Instructions dated 27 January 1954. Adjacent hydrographic sheets indexed in Descriptive Report for H-7932; 1951.

Field work for wire drag survey was started 25 April 1954 while the Ship HYDROGRAPHER was based at Key West Florida and suspended after one day's time in the field until 9 May 1954 when field work was completed. Due to heavy traffic in and out of Key West during the week, field work was confined to Sundays.

C. VESSEL AND EQUIPMENT:

All hydrographic work was accomplished by subparties from the Ship HYDROGRAPHER using Launches CS-115 and CS-117 to handle wire drag equipment. One of the Ship's dinghys was used for the wire drag tender.

Guide launch CS-117 was equipped with 808-J type Depth Recorder for use as an aid in setting wire drag depth. No record was kept of depth recorder soundings.

D. TIDE AND CURRENT STATIONS:

No tide or current stations were occupied within the limits of hydrography on this survey.

The observed tides at Key West tide station are to be used for reduction of soundings.

E. SMOOTH SHEET:

No work has been done on the smooth sheet aboard the HYDROGRAPHER and all records are forwarded to the Norfolk Processing Office.

F. CONTROL STATIONS:

Wire drag hydrography on this survey was controlled by three point sextant fixes taken on shore signals and/or fixed navigational aids. All signals are triangulation stations and source of control taken from Graphic Positions.

STATIONS USED:

SAND KEY Lighthouse (Monroe County, Fla., J.T. 1853; J.D.C. 1919)
BEACON P (Eastern Dry Rocks) (Monroe County, Fla., W.H.B. 1935;
E.R.M. 1936)
KEY WEST NAVAL RADIO Middle Tower (Monroe County, Fla., W.B.F. 1917;
Fla. Geod. S. 1919)
KEY WEST NAVAL RADIO South Tower (Monroe County, Fla., W.B.F. 1917;
Fla. Geod. S. 1919)
EAST TRIANGLE LIGHT (Monroe County, Fla., W.H.B. 1934)

G. SHORE LINE AND TOPOGRAPHY:

This is an offshore survey and no shore line or topography is shown on this sheet.

H. SOUNDINGS:

Wire Drag Survey.

I. CONTROL OF HYDROGRAPHY:

Wire drag hydrography on this survey was controlled by three point sextant fixes taken on shore signals and/or navigational aids.

J. ADEQUACY OF SURVEY:

This survey is complete for the area covered and adequate to show clearance to depth of drag.

L. COMPARISON WITH PRIOR SURVEYS:

M. COMPARISON WITH EXISTING CHARTS:

This report and survey is to supplement Survey H-7932 dated 1951.

N. DANGERS AND SHOALS:

None found.

O. COAST PILOT INFORMATION:

None.

P. AIDS TO NAVIGATION:

Floating aids to navigation within the limits of this survey were located by sextant fixes.

Q. LANDMARKS FOR CHART:

None.

U. MISCELLANEOUS:

Boat sheet submitted covers area of wire drag only and is within limits of Survey H-7932 dated 1951 which this survey is to supplement. ✓

Z. TABULATION OF APPLICABLE DATA:

Data listed to be forwarded to the Norfolk Processing Office with this report:

Wire drag record book Volume I
Boat Sheet

Respectfully submitted,



George W. Thompson
Ensign, USC&GS

Approved and Forwarded:



L. S. Hubbard
Captain, USC&GS
Commanding Officer
Ship HYDROGRAPHER

APPROVAL SHEET

The field work accomplished on this survey was under my immediate supervision. Daily inspection of work was made as survey progressed.

The records and boat sheet as submitted to the Norfolk Processing Office have been reviewed and approved by me.

L. S. Hubbard

L. S. Hubbard
Captain, USC&GS
Commanding Officer
Ship HYDROGRAPHER

STATISTICS FOR WIRE DRAG SURVEY
TO SUPPLEMENT HYDROGRAPHIC SURVEY

H-7932 (1951)

Volume Number	Day Letter	Date 1954	Number of Angles	Number of miles nautical
1	a	25 Apr.	39	4.4
1	b	9 May	36	2.8
TOTAL			<u>75</u>	<u>7.2</u>

TOTAL AREA: 1.2 Square Miles

GEOGRAPHIC NAMES

Survey No. F.E. 9-1954 W.D.

Name on Survey	A On Chart No.	B On previous survey No.	C On U. S. quadrangle Maps	D From local information	E On local Maps	F P. O. Guide or Map	G Rand McNally Atlas	H U. S. Light List	K	
										1
										2
										3
										4
										5
										6
										7
										8
										9
										10
										11
										12
										13
										14
										15
										16
										17
										18
										19
										20
										21
										22
										23
										24
										25
										26
										27

Hydrographic Surveys (Chart Division)

HYDROGRAPHIC SURVEY NO. E.E. 9-1954 W.D.

Records accompanying survey:

Boat sheets; sounding vols.; wire drag vols. ONE....;
 bomb vols.; graphic recorder rolls;
 special reports, etc. 1. descriptive Report, 2 transmitting letters,
 1. smooth sheet.....

The following statistics will be submitted with the cartographer's report on the sheet:

Number of positions on sheet	75
Number of positions checked	25
Number of positions revised	0
Number of soundings revised (refers to depth only)	0
Number of soundings erroneously spaced	2
Number of signals erroneously plotted or transferred	0
Topographic details	Time
Junctions	Time
Verification of soundings from graphic record	Time

Verification by *Lu Zeskind* Total time *16* Date *June 23, 1955*
 Reviewed by *Lu Zeskind* Time *4* Date *June 24, 1955*

RHC

TIDE NOTE FOR HYDROGRAPHIC SHEET

~~DIVISION OF HYDROGRAPHY AND TOPOGRAPHY~~

19 January 1955

Division of Charts: R. H. Carstens

Plane of reference approved in
1 volume of ~~soundings records for~~ wire drag records for

~~HYDROGRAPHIC SHEET~~

FE No. 9 1954

Locality Straits of Florida

Chief of Party: L. S. Hubbard in 1954
Plane of reference is mean low water, reading
4.3 ft. on tide staff at Key West
8.8 ft. below B. M. 29 (1923)

Height of mean high water above plane of reference is 1.3 feet.

Condition of records satisfactory except as noted below:

E. C. McKay
Tides Branch

Chief, Division of Tides and Currents.

Review of Field Examination No. 9, 1954

This wire-drag field examination was made in compliance with the Director's Instructions for Project CS-328, dated 27 January 1954.

The purpose of the field examination was to cover by wire drag to an effective depth of 60 ft. an area extending 0.3 mile in all directions from the charted position of the wreck ROSE MARY in lat. $24^{\circ}27.7'$, long. $81^{\circ}48.35'$.

The area around the wreck was wire-dragged to an effective depth of 62 ft. and no evidence of the wreck was found.

The wreck has been deleted from Chart 1251 dated 3-14-55 subsequent to the field examination. (See Review H-7932 (1951)). No conflicts between depths shown on Chart 1251 and the field examination are noted.

A comparison between H-7932 (1951) and the present wire-drag work shows the effective wire-drag depths to be in harmony with depths on H-7932.

The results of the field examination are shown on the accompanying 2 sheets.

The Descriptive Report adequately covers all other matters pertaining to this examination. No further discussion is considered necessary.

Reviewed by - I. M. Zeskind
6-23-55

Inspected by - R. H. Carstens

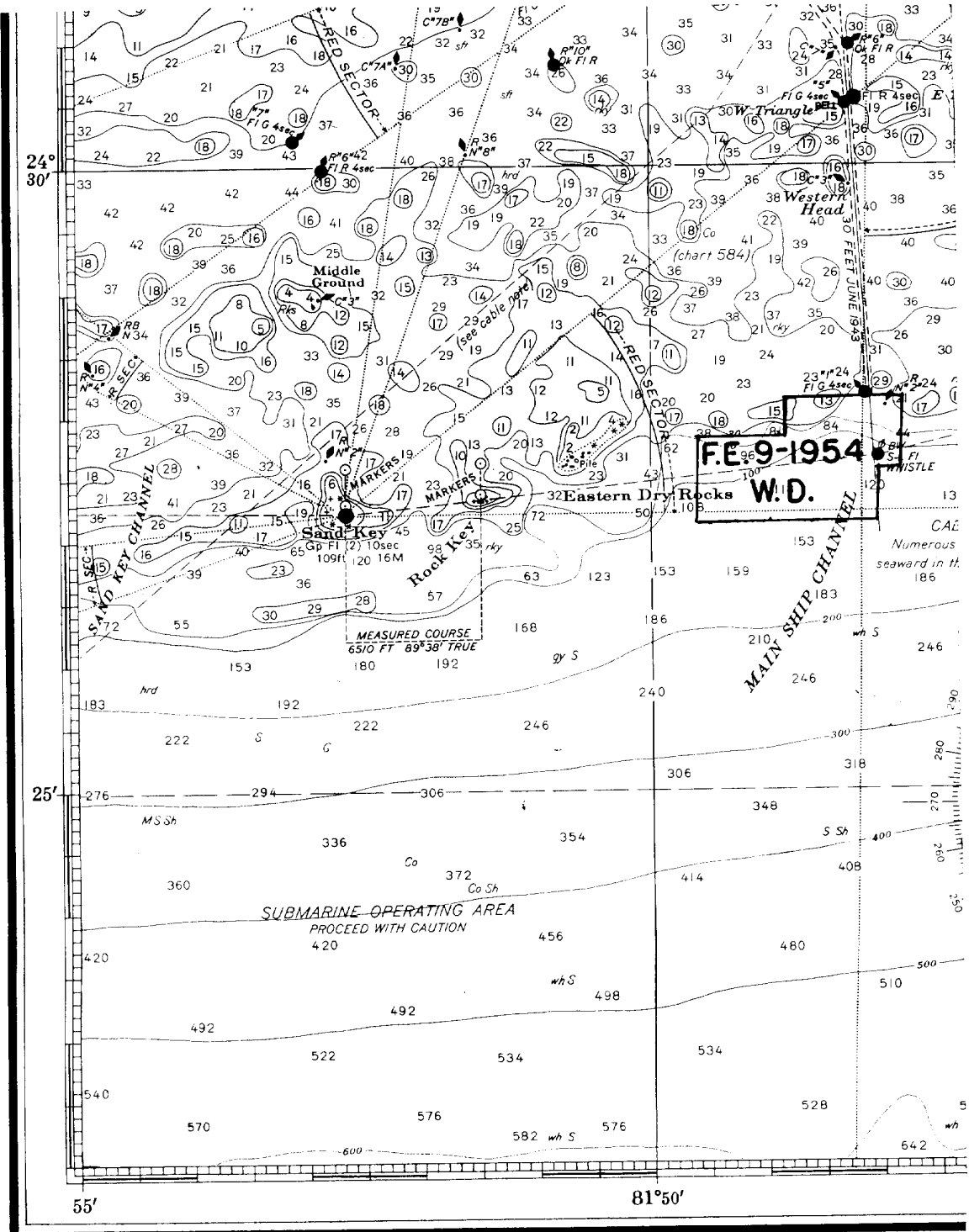

54-426

1251 PRICE \$1.00

5 21 5: VJM

F.E. NO. 9 1954
 STRAITS OF FLORIDA
 VICINITY OF KEY WEST
 Ship Hydrographer
 Scale 1:20,000
 Sheet 2 of 2

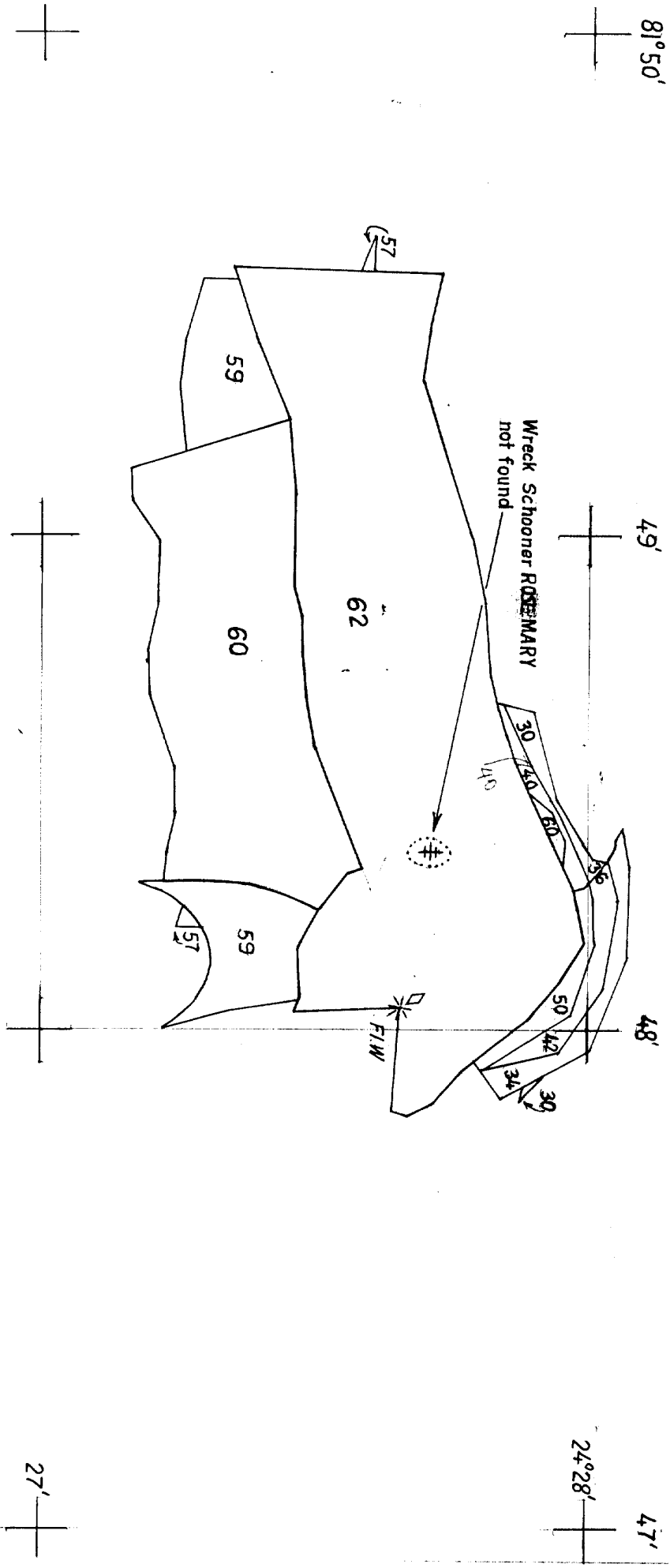

Fe. 9-1954

81°49'

48'

47'

F. E. No. 9, 1954

STRAITS OF FLORIDA VICINITY OF KEY WEST

Scale-1:20,000 Ship Hydrographer

Sheet 1 of 2

hung at 42 ft

Wreck Schooner ROSE MARY
cleared by 62 ft.

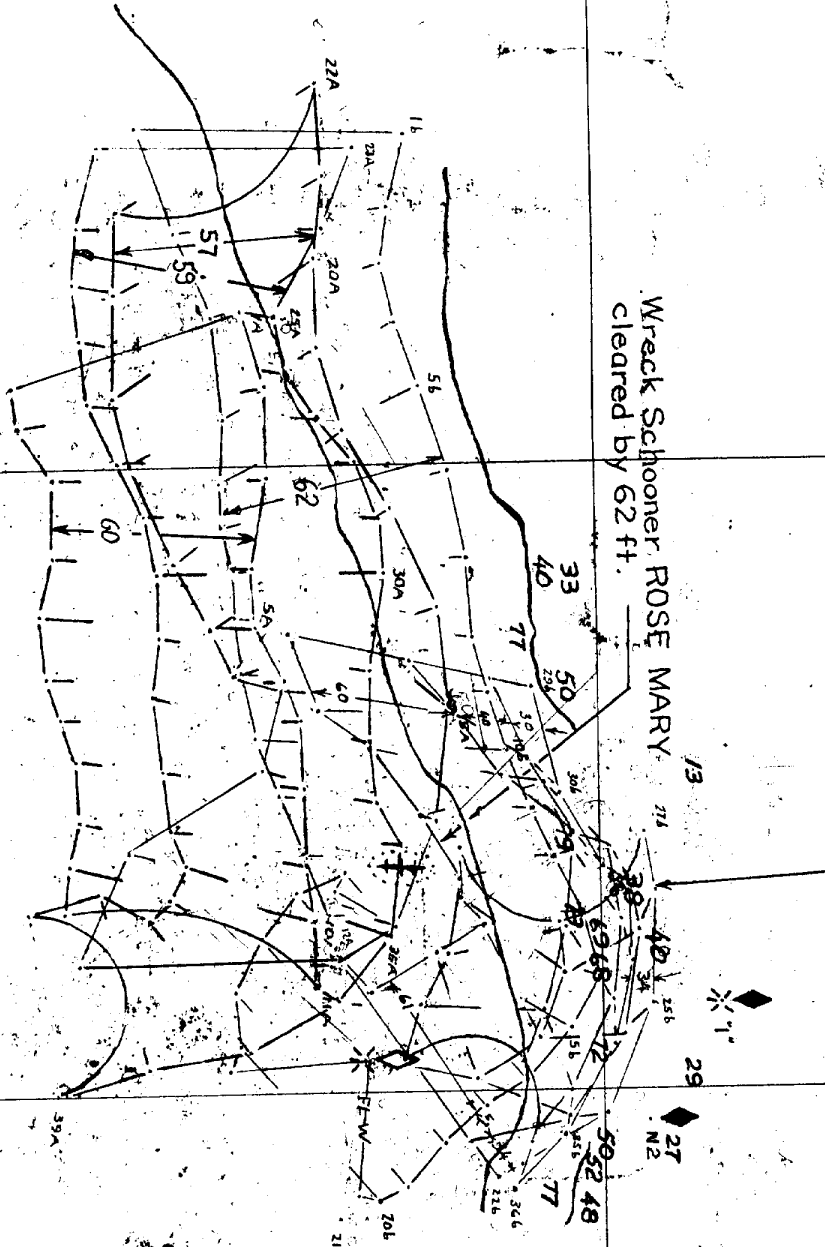

24°28'

27'

