

# FE 189

## WIRE DRAG

Diagram No. 1211-2

NOAA FORM 76-35A

U.S. DEPARTMENT OF COMMERCE  
NATIONAL OCEANIC AND ATMOSPHERIC ADMINISTRATION  
NATIONAL OCEAN SURVEY

### DESCRIPTIVE REPORT (HYDROGRAPHIC)

Type of Survey ... Field Examination  
Field No. .... WA\*HI-10-3-61  
Office No. .... FE-189

#### LOCALITY

State ..... Rhode Island  
General Locality .. Block Island Sound & Long  
Island Sound  
Locality .....  
Watch Hill Point  
19 63  
CHIEF OF PARTY  
E. K. McCaffrey

#### LIBRARY & ARCHIVES

DATE ..... October 25, 1963

☆ U.S. GOV. PRINTING OFFICE: 1978-666-172

NOTE: A new system for registering Field Examinations (FE's) was established in 1980. All FE's are now consecutively numbered as shown hereon. The date shown in the new format is the actual date of survey. This material was previously registered as;

FE No. 3 1963

FE 189

# F E No. 3 1963

Diag. Cht. No. 1211-2.

Form 504

U. S. DEPARTMENT OF COMMERCE  
COAST AND GEODETIC SURVEY

## DESCRIPTIVE REPORT

Type of Survey \_\_\_\_\_

Field No. WA\*HI-10-3-67 Office No. F.E.No. 3-1963  
(1963)

### LOCALITY

State Rhode Island

General locality Block I. Sound & Long I.  
Sound.

Locality Watch Hill Point

19 63

### CHIEF OF PARTY

E. K. McCaffrey

### LIBRARY & ARCHIVES

DATE October 25, 1963

USCOMM-DC 5087

F E No. 3  
1963

*See also L-1041(1961)*  
L-1041/61  
Ref: L-1259/62

Chts 116-1  
358 App'd 5-5-64 GEM  
1211  
1108

~~DEL~~  
~~7/10/63~~

DEPARTMENT OF COMMERCE

U. S. COAST AND GEODETIC SURVEY

HYDROGRAPHIC TITLE SHEET

The Hydrographic Sheet should be accompanied by this form, filled in as completely as possible, when the sheet is forwarded to the Office.

REGISTER No. F.E.No. 3, 1963

Field No. WA-HI-10-3-61

State Rhode Island

General locality Block Island Sound and Long Island Sound

Locality Watch Hill Point

Scale 1 : 10,000 Date of survey 9-12 May 1963

Instructions dated 3/19/63

Vessel Wainwright and Hilgard

Chief of party E. K. McCaffrey

Surveyed by \_\_\_\_\_

Soundings taken by fathometer, graphic recorder, hand lead, wire \_\_\_\_\_

Fathograms scaled by \_\_\_\_\_

Fathograms checked by \_\_\_\_\_

Protracted by \_\_\_\_\_

Soundings penciled by \_\_\_\_\_

Soundings in fathoms feet at MLW MLLW

REMARKS: \_\_\_\_\_

\_\_\_\_\_

\_\_\_\_\_

\_\_\_\_\_

\_\_\_\_\_

\_\_\_\_\_

*JMS*

UNITED STATES GOVERNMENT

# Memorandum

TO : Director  
Coast & Geodetic Survey

DATE: 8/4/63

FROM : Commanding Officer  
USC&GS Ships WAINWRIGHT & HILGARD  
% General Delivery, Fairhaven, Mass.

SUBJECT: SPECIAL REPORT - SPECIAL PROJECT 1-63 - PRESURVEY REVIEW  
ITEM 16-A, OPR-414, WATCH HILL POINT, RHODE ISLAND

REFERENCE: SPECIAL PROJECT 1-63, INSTRUCTIONS 2100 B-pt, S-2-W&H  
dated 19 March 1963

In accordance with referenced instructions, a hydrographic and wire drag investigation was conducted off Watch Hill Point, Rhode Island (Sugar Reef Passage) for the reported obstruction on chart 358, 1500 yards, 216°T from Watch Hill Light. A list of signals used for position control is attached. The hydrographic development covered approximately 0.1 square miles of closely spaced lines and the wire drag covered 0.2 nautical square miles.

*PSR item 16A  
Proj. CS-414*

The results of the survey may be summarized as follows:

1. A hydrographic examination failed to verify the existence of the charted reported obstruction.
2. Shoal soundings of 12, 16, and 17 feet were picked up by the echo sounder and appear to verify the position of the charted 10, 12, and 15-foot shoals just south of the reported obstruction. No leadlines were obtained due to rough seas and currents.
3. A wire drag investigation, using the HILGARD and launch CS-181 hung an obstruction near the charted 10' with an effective drag depth of 13 feet. This hang and the reported obstruction were subsequently cleared to an effective depth of 10 feet. *10.4 ft on H-8708 (1961-66)*

*(N.M. 2 JAN 11 1964)*

It is recommended that the charted obstruction be deleted from this area. The charted 10, 12, and 15-foot soundings should remain as charted.

Tidal data was furnished by the Washington office from the standard gage at New London, Connecticut, in the form of a tabulation of inferred hourly heights for Watch Hill Point, Rhode Island.

Accepted hydrographic methods were followed, with 3-point sextant fixes used for control. Existing control points were used in all cases.

*Edwin K. McCaffrey*  
Edwin K. McCaffrey

Encl.: Overlays of WA-HI 10-3-61

EKM/jrb

L I S T   O F   S I G N A L S

SP-1-63

TRIANGULATION:

| <u>Signal name</u> | <u>Source</u>                              |
|--------------------|--|
| OCEAN              | Cupola (hotel) Ocean House flagstaff, 1934 |
| WATCH              | Watch Hill Lighthouse, 1873                |

PHOTO-HYDRO:

|     |        |
|-----|--------|
| MOP | RS-715 |
| DID | RS-714 |

RHC

TIDE NOTE FOR HYDROGRAPHIC SHEET 1/3/64

Nautical Chart Division: R. H. CARSTENS

Plane of reference approved in  
4 volumes of sounding records for

HYDROGRAPHIC SHEET FE NO 3 1963

Locality Watch Hill Point, Rhode Island

Chief of Party: E. K. McCaffrey

Plane of reference is Mean Low Water.

ft. on tide staff at

ft. below B. M.

Height of Mean High Water Above Plane of Reference is: 2.5 Ft.

Condition of records satisfactory except as noted below:

*J. M. Symons*  
Chief, Tides and Currents Branch

Hydrographic Surveys (Chart Division)

HYDROGRAPHIC SURVEY NO. F.E.No.3-1963

Records accompanying survey: Smooth sheets ...<sup>2</sup>;  
 boat sheets .....; sounding vols. ..<sup>2</sup>...; wire drag vols. ..<sup>2</sup>...;  
 Descriptive Reports ...<sup>1</sup>...; graphic recorder envelopes ...<sup>1</sup>...;  
 special reports, etc. Velocity corrections "A,B,C & D" days  
 filed with fathograms.....

The following statistics will be submitted with the cartographer's report on the sheet:

|   |      |                     |
|---|------|---------------------|
| Number of positions on sheet                            |      | 163                 |
| Number of positions checked                             |      | 11                  |
| Number of positions revised                             |      | 0                   |
| Number of soundings revised<br>(refers to depth only)   |      | 0                   |
| Number of soundings erroneously spaced                  |      | .....               |
| Number of signals erroneously plotted<br>or transferred |      | .....               |
| Topographic details                                     | Time | .....               |
| Junctions   | Time | .....               |
| Verification of soundings from<br>graphic record        | Time | ... <sup>1</sup> .. |
| Special adjustments                                     | Time | .....               |

Verification by *Frederic R. Scarcello* Total time *16* Date *Jan 8, 1965*

Reviewed by *Frederic R. Scarcello* Time *5* Date *Jan 8, 1965*

Review - Field Examination No. 3, 1963  
Sugar Reef Passage - Block Island Sd., R. I.

1. The field examination was made in compliance with Instructions for Special Project No. 1, dated March 19, 1963.
2. The purpose of the examination was to make a hydrographic and wire drag investigation to determine the existence and location of an uncharted obstruction 1500 yards, 216 degrees true from Watch Hill Light. The M. V. SUNOCO reported striking this obstruction on September 20, 1961 (Ch.L. 1041/61).
3. The results of the examination are shown on the two accompanying cloth tracings.

No obstruction was found at the reported location.

The effective depths of the wire drag of the present survey are in harmony with the hydrography obtained by the present survey and contemporary survey H-8708 (1961-62).

4. Comparison with Chart 358 (Latest Print Date 7-7-64)

Minor differences of 1-2 ft. are generally noted between the charted and present survey depths except in several instances where greater differences occur because of slight displacements on steep slopes.

Attention is directed to the following discrepancies between the charted soundings and the effective wire drag depths of the present survey.

- a. The 12-ft. sounding charted in lat.  $41^{\circ}17.53'$ , long.  $71^{\circ}52.08'^{31.8}$  from chart letter 1259 (1962) was cleared by a wire drag of the present survey set to an effective depth of 13 ft. However, the 12 ft. is not considered disproved and it is recommended that it be retained on the chart.



FE 3, 1963 - 2

- b. The 10-ft. sounding charted in lat.  $41^{\circ}17.57'$ <sup>34.2</sup>, long.  $71^{\circ}52.03'$ <sup>33</sup> from H-8708 (1961-62) prior to verification and review, was revised to 11 ft. during verification of H-8708.
- c. The 10-ft. sounding charted in lat.  $41^{\circ}17.55'$ <sup>33</sup>, long.  $71^{\circ}52.03'$ <sup>33</sup> from chart letter 1259 (1962) was cleared by a wire drag of the present survey set to an effective depth of 13 ft. The charted 10-ft. sounding is believed to be plotted out of position and should actually fall about 46 meters to the northward where a ~~11~~ ft. sounding falls on H-8708 (1961-62). The charted 10 ft. should be deleted from the chart.

The Descriptive Report covers all other matters pertaining to this examination. No further discussion is considered necessary.

Reviewed by F. R. Scarcella  
1/8/65

Inspected by I. M. Zeskind

\* This 11 ft depth at lat.  $41^{\circ}17.57'$  long.  $71^{\circ}52.03'$  was deleted and replaced with a 10 ft depth (10~~4~~ ft) during inspection of H-8708.

J. T. Gallahan  
12-13-77

71° 47' 18" 00"

52' 30"

71° 52'

71° 52' 00"

41° 18'

71° 51' 30"

18' 00"

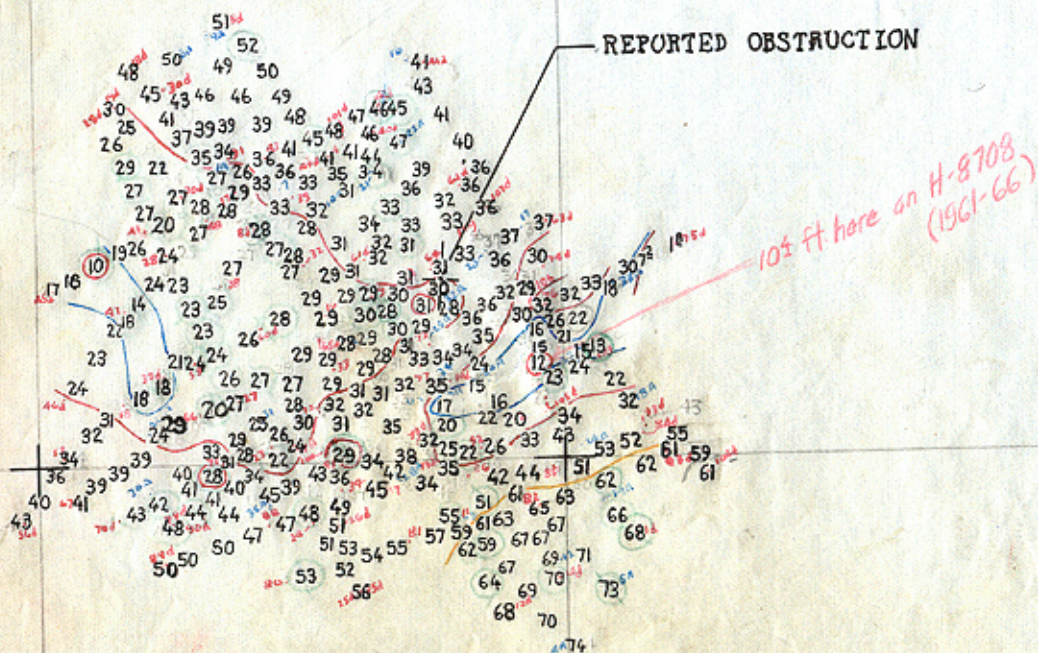

REPORTED OBSTRUCTION

10± ft here on H-8708 (1961-66)

52' 30"

52'

41° 17' 30"

FIELD EXAMINATION No. 3, 1963  
 USC&GSS WAINWRIGHT-HILGARD  
 SPECIAL PROJECT 1-63  
 PRESURVEY REVIEW ITEM 16-A, OPR-414  
 HYDROGRAPHIC INVESTIGATION  
 WATCH HILL POINT, RHODE ISLAND  
 SCALE OF SHEET WA-HI 10-3-61  
 MAY 1963 Soundings in feet at MLW  
 LCDR. E.K. McCAFFREY, CHIEF OF PARTY  
 SCALE 1:10,000

71° 52' 30" 41° 18' 00"

11052'00"

71° 51' 30"

18'00"

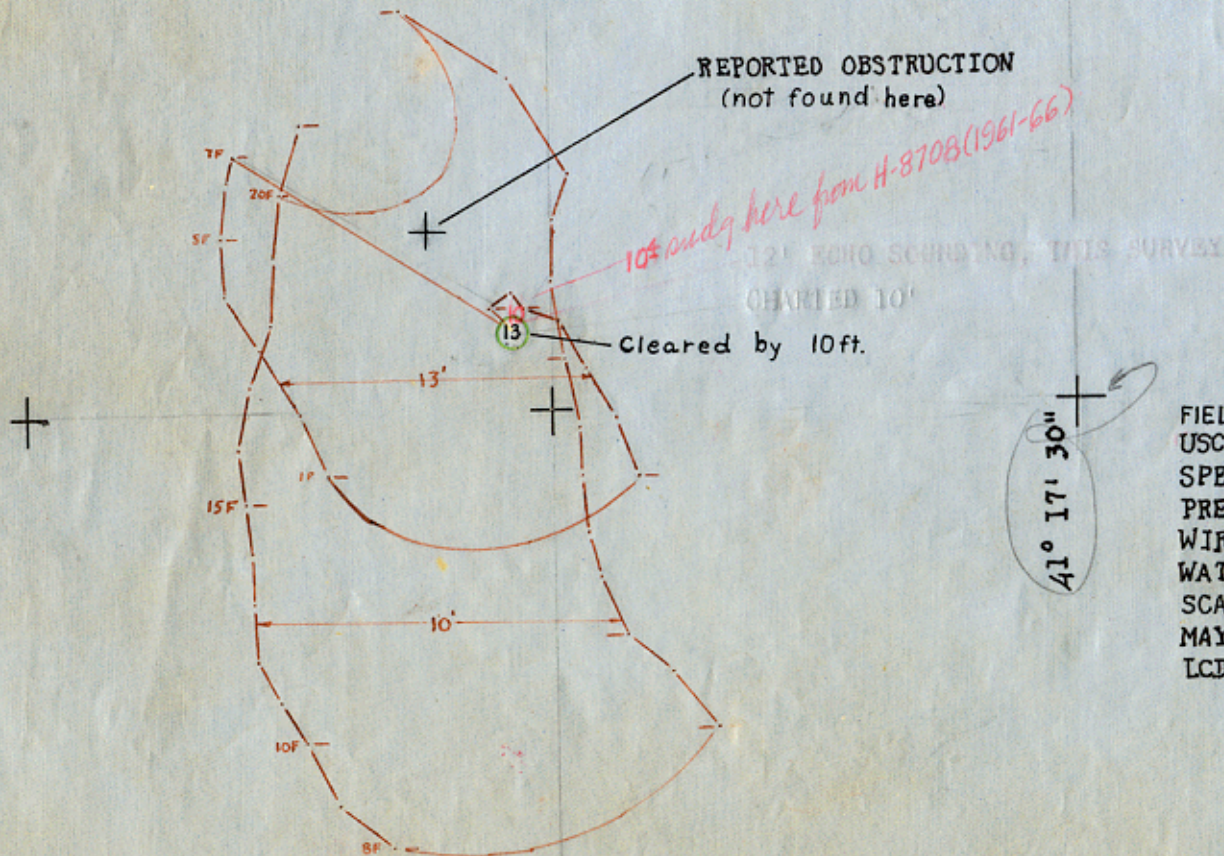

FIELD EXAMINATION No. 3, 1963  
USC&GSS WAINWRIGHT-HILGARD  
SPECIAL PROJECT 1-63  
PRESURVEY REVIEW ITEM 16-A, OPR-474  
WIRE DRAG INVESTIGATION  
WATCH HILL POINT, RHODE ISLAND  
SCALE OF SHEET WA-HI 10-3-61  
MAY 1963 1:10,000  
LCDR. E.K. McCAFFREY, CHIEF OF PARTY

41°18'

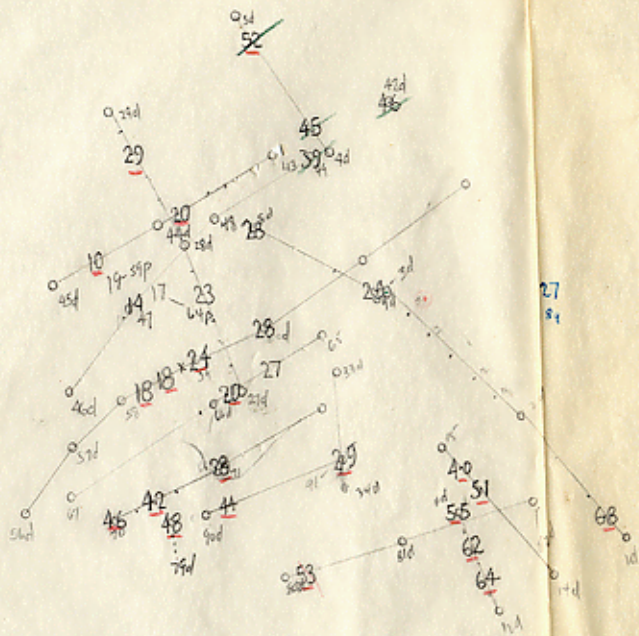

71°52'

41°17'

FE 3, 1963 ARMY

51'



$41^{\circ}18'$   
 $71^{\circ}52'$

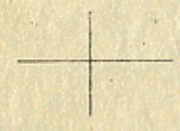
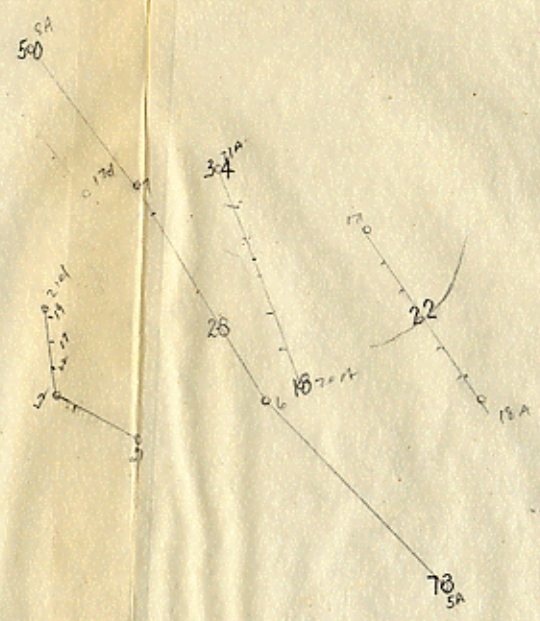

71°52'

41°18'

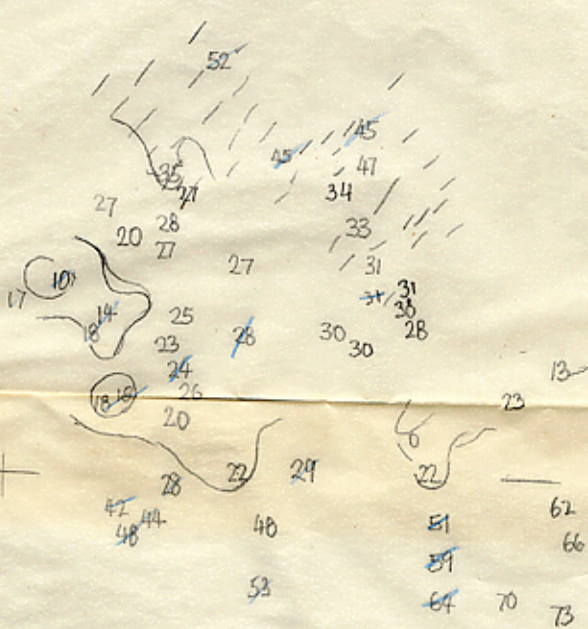

FE 3, 1963



**NOTE A**

Navigation regulations are published in Chapter 2, Coast Pilot 2, or subsequent yearly supplements and weekly Notices to Mariners. Copies of the regulations may be obtained at the office of the District Engineer, Corps of Engineers in Waltham, Mass. Refer to section numbers shown with area designation.

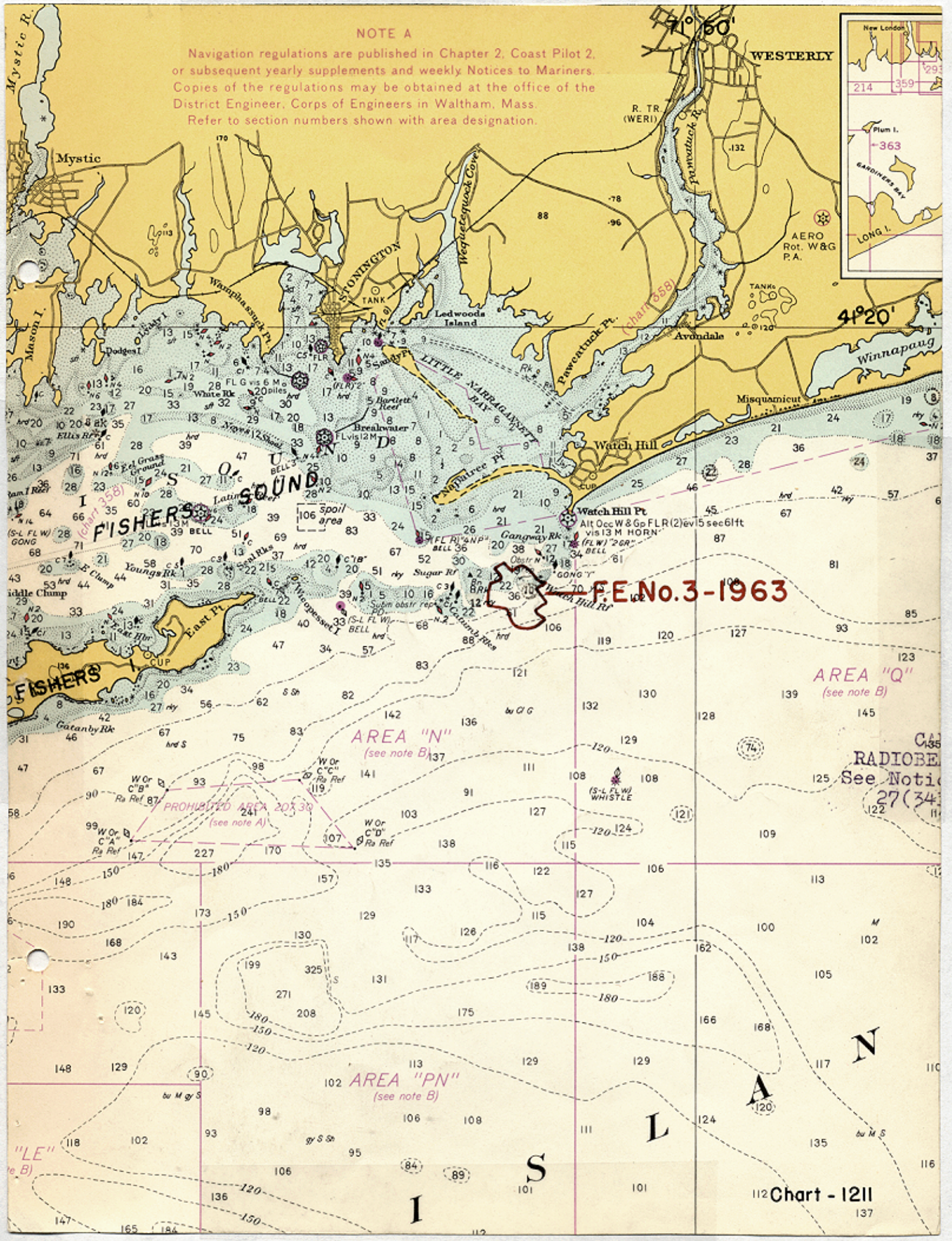

**F.E.No.3-1963**

**AREA "N"**  
(see note B)

**AREA "Q"**  
(see note B)

**AREA "PN"**  
(see note B)

**RADIOBEACON**  
See Notice  
27(34)

**A**

**L**

**S**

**I**

**N**

**A**

**L**

**S**

**I**

**Chart - 1211**

137

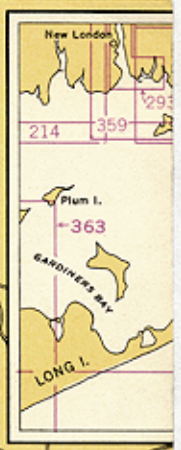

**WESTERLY**

R. TR (WERI)

AERO Rot. W&G P.A.

4°20'

132

Avondale

Watch Hill

Watch Hill Pt

Alt Occ W & Go FLR (2) ev 15 sec 61ft  
vis 13 M HORN  
(FLW) 2 GR  
34 BELL

Obstr N 12 E

GONG Y

Watch Hill Rk

Obstr N 12 E

106

120

127

123

139

145

128

129

130

127

121

136

132

129

111

108

108

(S-L FLW) WHISTLE

120

124

115

106

109

113

100

102

105

166

168

117

110

124

135

116

101

112

116

112

116

112

116

112

116

112

116

112

116

112

116

112

116

112

116

112

116

112

116

112

116

112

116

112

116

112

116

112

116

112

116

112

116

112

116

112

116

112

116

112

116

112

116

112

116

112

116

112

116

112

116

112

116

112

116

112

116

112

116

112

116

112

116

112

116

112

116

112

116

112

116

112

116

112

116

112

116

112

116

112

116

112

116

112

116

112

116

112

116

112

116

112

116

112

116

112

116

112

116

112

116

112

116

112

116

112

116

112

116

112

116

112

116

112

116

112

116

112

116

112

116

112

116

112

116

112

116

112

116

112

116

112

116

112

116

112

116

112

116

112

116

112

116

112

116

112

116

112

116

112

116

112

116

112

116

112

116

112

116

112

116

112

116

112

116

112

116

112

116

112

116

112

116

112

116

112

116

112

116

112

116

112

116

112

116

112

116

112

116

112

116

112

116

112

116

112

116

112

116

112

116

112

116

112

116

112

116

112

116

112

116

112

116

112

116

112

116

112

116

112

116

112

116

112

116

112





